

LA CONVENTION CENTER EXPANSION



PROJECT GOALS

- Develop a convention center with:
 - Over 910,000 sq. ft. of exhibition space
 - Over 175,000 sq. ft. of meeting rooms
 - Premium rooftop flex space that can function as exhibit, ballroom or meeting rooms.
- Provide over 750,000 sq. ft. of contiguous exhibition space to create a top convention center destination in California and among the most competitive in the country
- Completely redevelop and revitalize Gilbert Lindsay Plaza
- Develop a complete project that delivers a fully integrated 100 acre L.A. LIVE/LA Convention Center campus which includes over 2,240 hotel rooms enhancing the attractiveness of LA as a prime location for large groups



PROJECT STRUCTURE: DBFOM DEVELOPMENT MODEL

- Public-private partnership (P3) between the City of Los Angeles and AEG + Plenary Group
- DBFOM structure enables accelerated project execution facilitated by private sector efficiencies
- Private funding secured by developer, not dependent on issuance of public bonds
- Developer has responsibility to deliver project on time and on budget



LA

**City
Tourism**
DEPARTMENT

LOS ANGELES CONVENTION CENTER EXPANSION

New Multipurpose Space: 90,000-100,000 SF

New Meeting Space: 20,000-30,000 SF

New Exhibit Hall: 180,000-200,000 SF

New Georgia Street Entry
Elevated Connection To Hotel

Expanded LA Live Way
Parking Garage

Headquarters Hotel Expansion:
850 Rooms
109,700 SF Meeting Space
Including a 51,300 SF Ballroom

Venice Garage

JW Marriot

Microsoft Theater

Staples Center

Figeroa Street

Pico Boulevard

LA Live Campus

Re-designed Gilbert Lindsay Plaza: 140,000 SF

LACC CAMPUS PROGRAM
- Total Contiguous Exhibition Space Increases to Approximately 750,000 SF (Total of 910,000 SF of Exhibit Space)
- Total Meeting/Event hall Space Increases to Approximately 175,000 SF (78 Meeting Rooms Total)
- New Upper Multipurpose Hall of Approximately 95,000 SF (For Exhibits or Divisible into 40 Meeting Rooms)
- Total Useable LACC Space With Proposed Expansion: **APPROXIMATELY 1,180,000 SF**

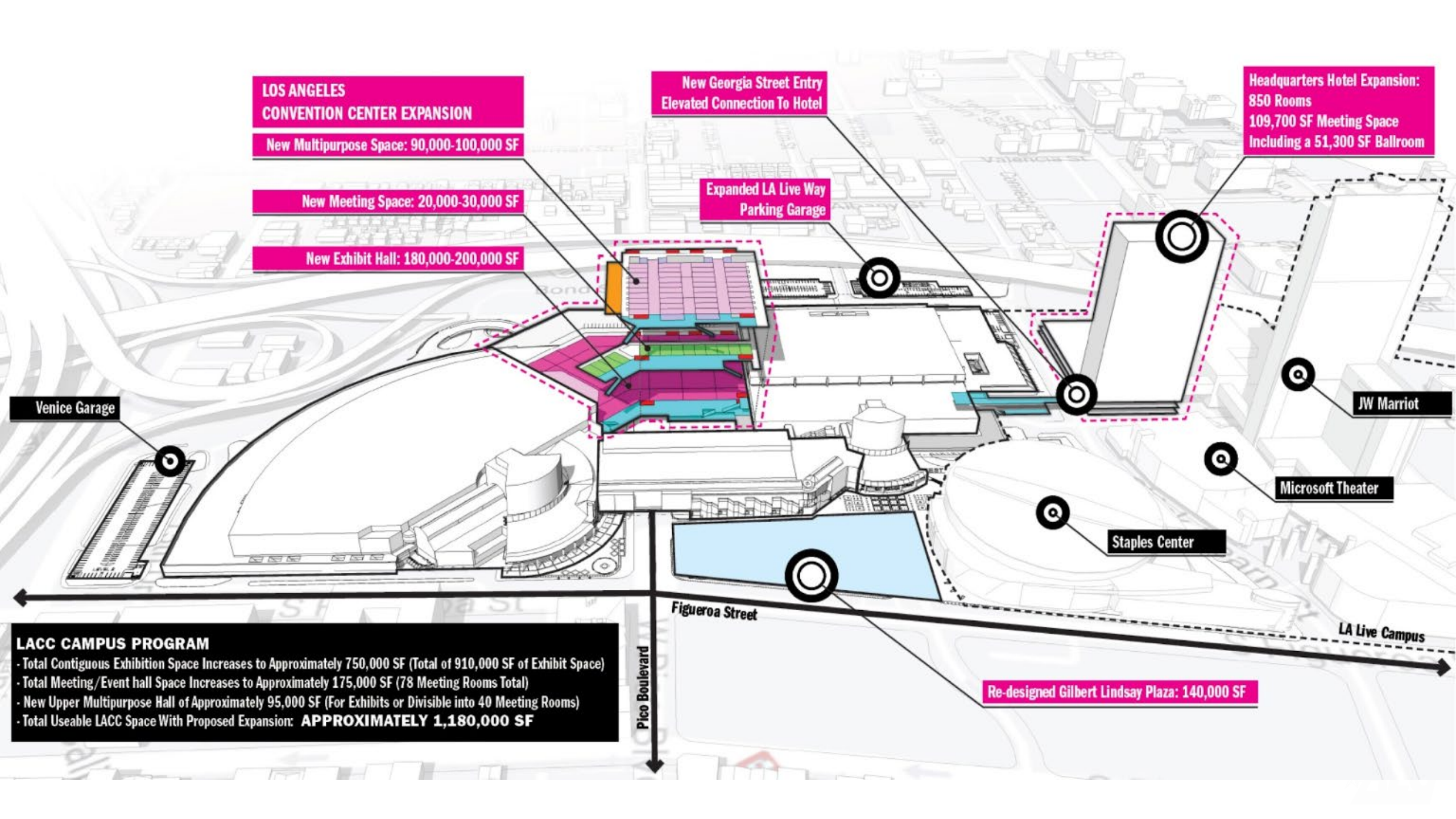

DISTRICT CIRCULATION

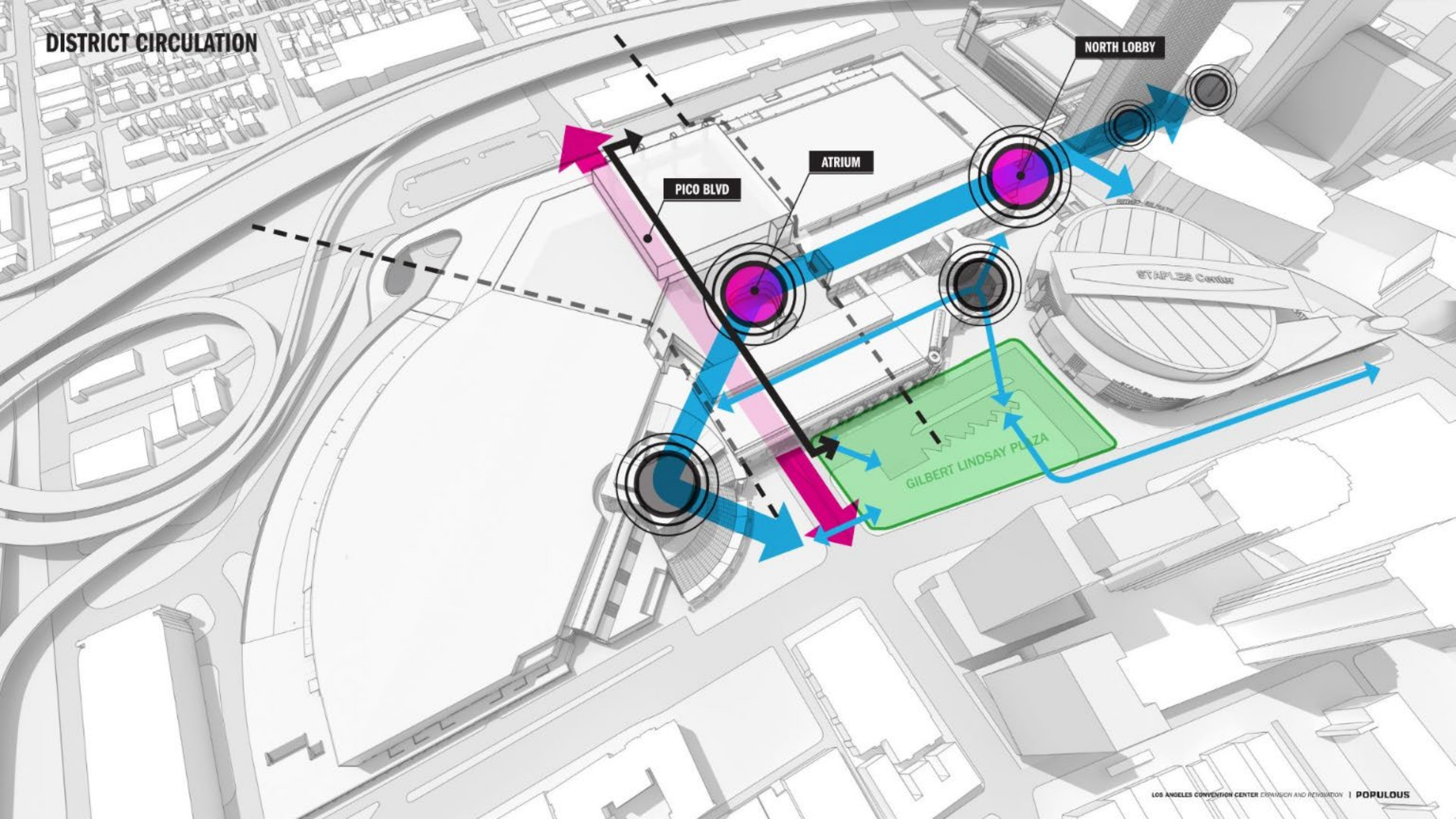
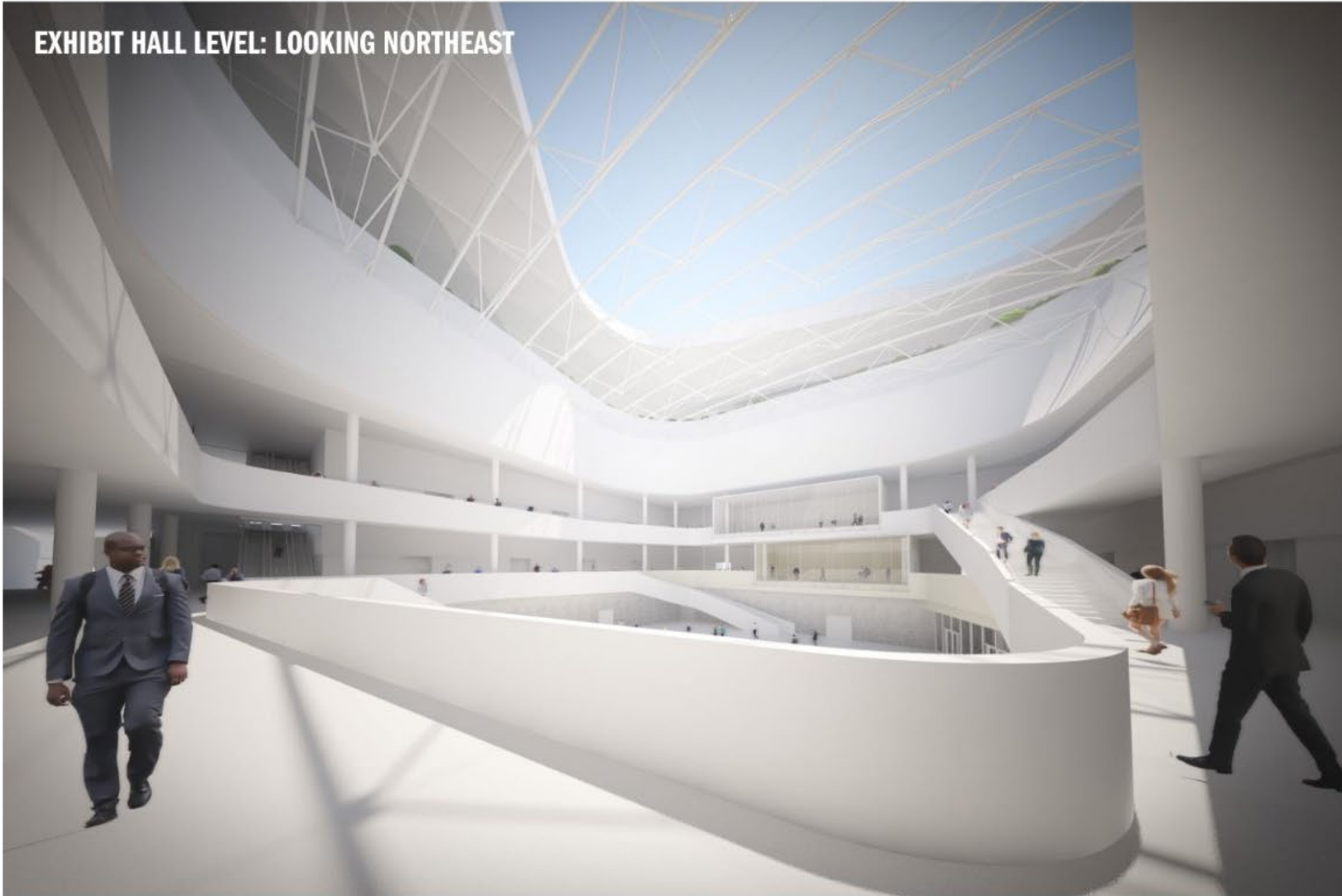
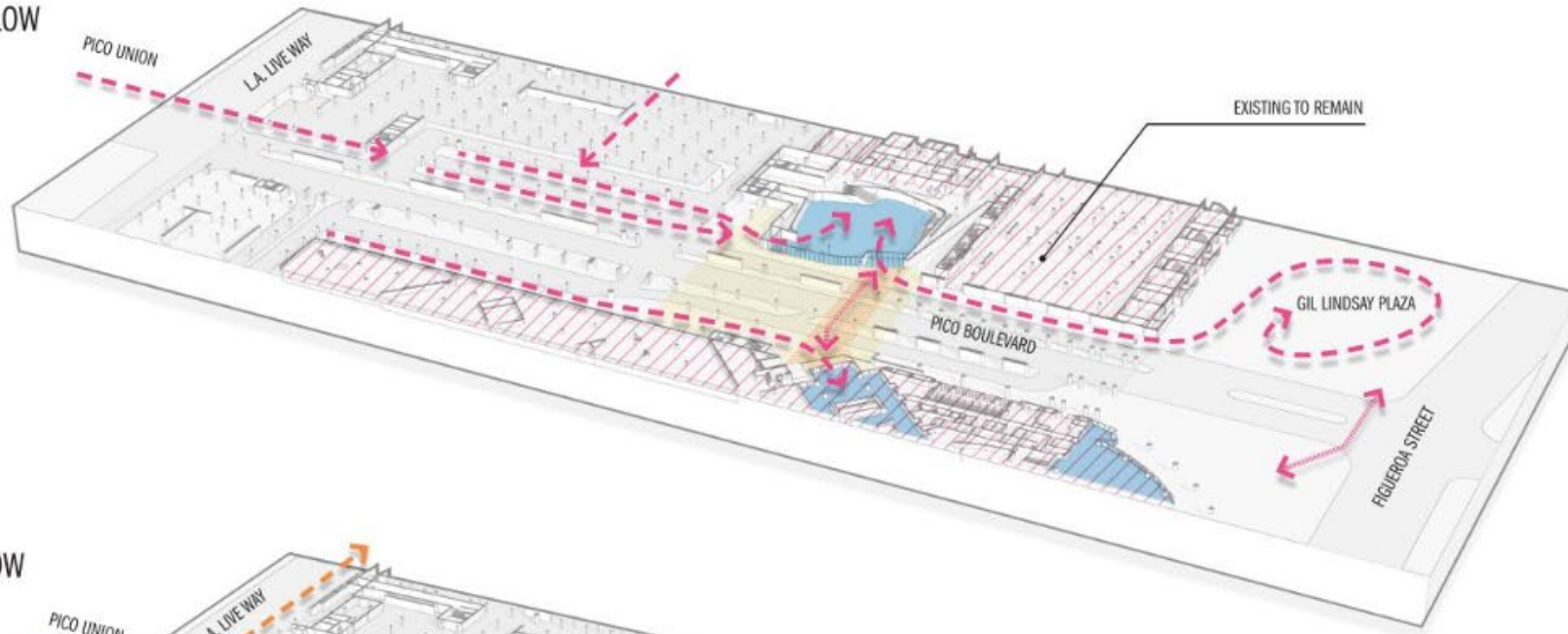

EXHIBIT HALL LEVEL: LOOKING NORTHEAST



PICO PASSAGE: FLOW

PEDESTRIAN FLOW



VEHICULAR FLOW



MULTI-PURPOSE SPACE

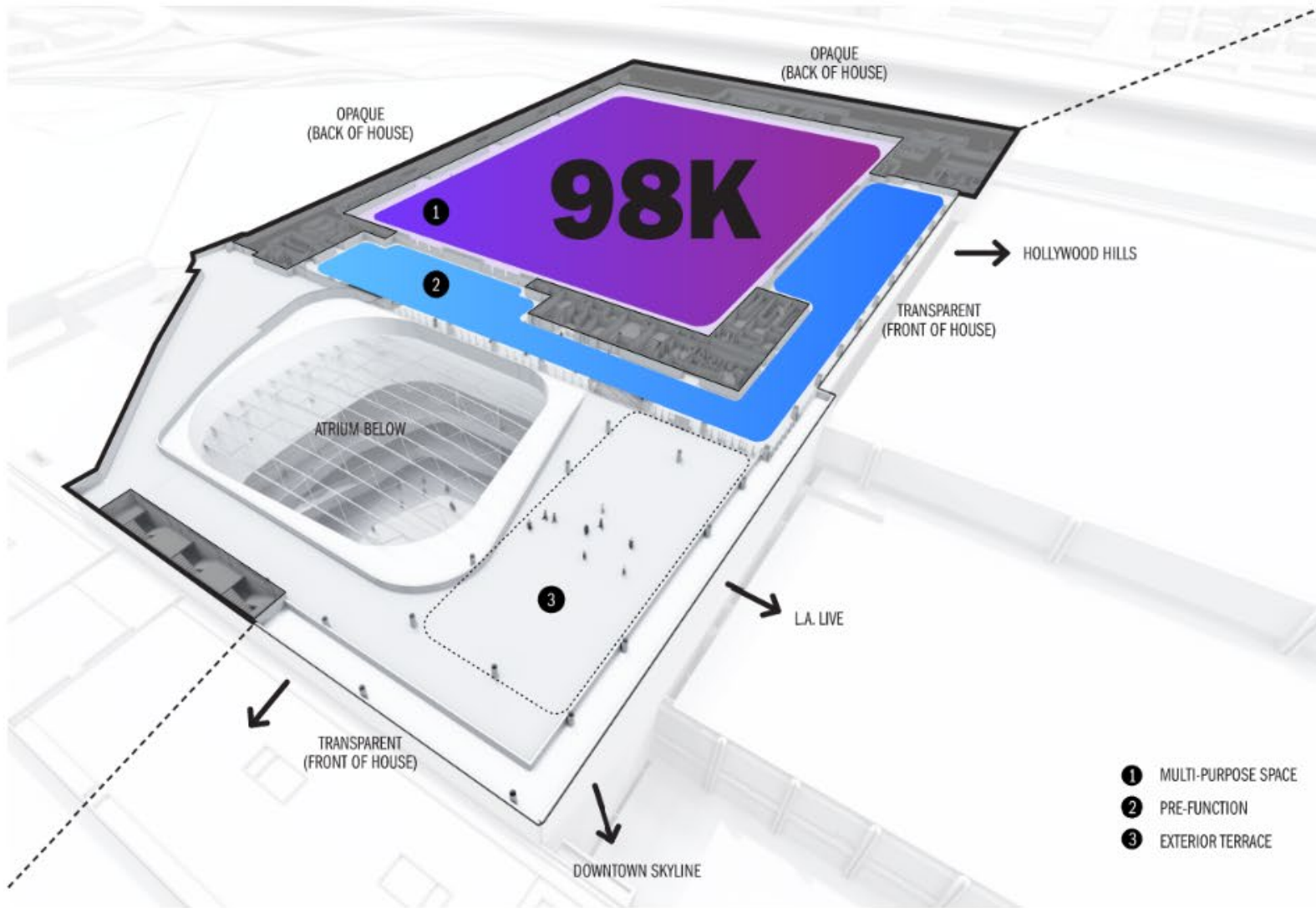

- 1 MULTI-PURPOSE SPACE
- 2 PRE-FUNCTION
- 3 EXTERIOR TERRACE

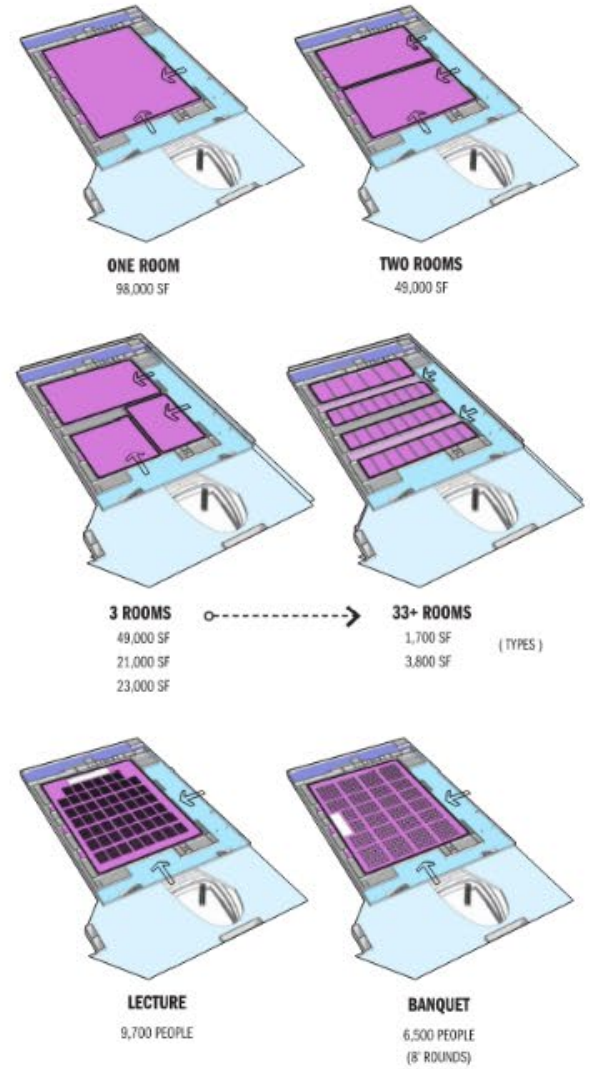

EXTERIOR TERRACE TOWARDS HOLLYWOOD HILLS

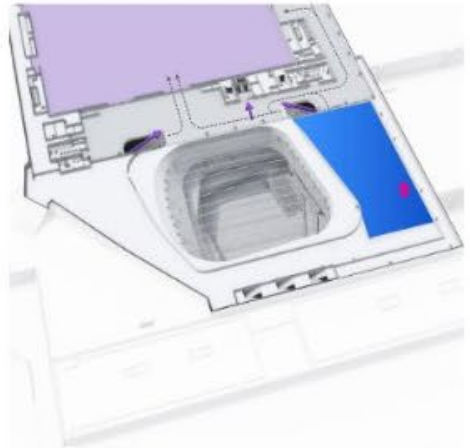

EXISTING GILBERT LINDSAY PLAZA



REIMAGINED GILBERT LINDSAY PLAZA

- *Flexible space for event programming*
- *Gardens and green space*
- *Better pedestrian experience*
- *Stronger connection to L.A. LIVE*



REIMAGINED GILBERT LINDSAY PLAZA

- *Flexible space for event programming*
- *Gardens and green space*
- *Better pedestrian experience*
- *Stronger connection to L.A. LIVE*



REIMAGINED GILBERT LINDSAY PLAZA



EXPANSION PROJECT SCHEDULE

- Resume Design – early 2023
- Complete Design – end of 2023
- Construction Start – early 2024
- Project Completion – mid 2026
- Dates subject to City Council approval



LA

**City
Tourism**
DEPARTMENT

JW MARRIOTT HOTEL EXPANSION

New 40-story hotel, adding 850 rooms



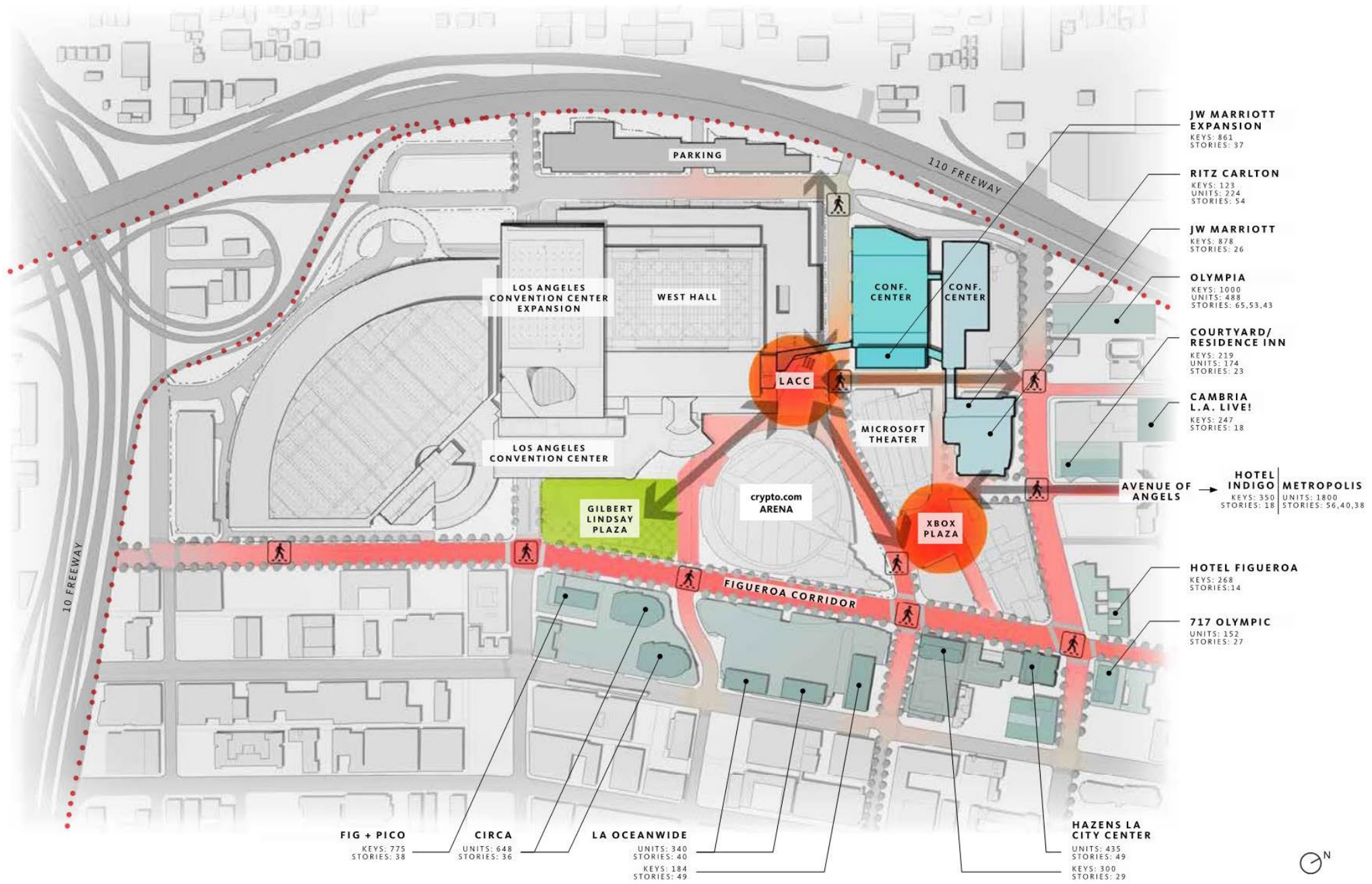

HOTEL ROOMS WITHIN WALKING DISTANCE OF LACC

There are 18 existing hotels and four hotels currently under construction for a total of 6,600 hotel rooms within walking distance

EXISTING AS OF JULY 1, 2013		
1	JW Marriott Los Angeles L.A. LIVE	878
2	Sheraton Los Angeles (The Bloc)	485
3	Figuroa Hotel	268
4	Stillwell Hotel	232
5	Mayfair Hotel	215
6	E-Central Downtown Los Angeles Hotel	175
7	The Wayfarer Downtown LA	156
8	Ritz-Carlton Los Angeles L.A. LIVE	123
9	O Hotel	67
Subtotal		2,599
OPENED AFTER JULY 1, 2013		
10	InterContinental Los Angeles Downtown	889
11	Hotel Indigo (Metropolis)	350
12	LEVEL Furnished Living	303
13	Freehand Hotel and Hostel	226
14	Residence Inn Los Angeles L.A. LIVE	219
15	Ace Hotel	182
16	Courtyard Los Angeles L.A. LIVE	174
17	Hoxton Downtown LA	174
18	The Downtown LA Proper	148
Subtotal		2,665
UNDER CONSTRUCTION		
19	Fig+Pico Conf. Center Hotels (Lightstone) Ph. I	820
20	Trinity Hotel (Chetrit Group)	183
21	Park Hyatt (Oceanwide Plaza)	183
22	Broadway Trade Center (Waterbridge)	150
Subtotal		1,336



**RECENTLY
OPENED**

**174
ROOMS**



HOXTON HOTEL

**148
ROOMS**



DOWNTOWN LA PROPER

**UNDER
CONSTRUCTION**

**820
ROOMS**



**FIG + PICO CONF. CENTER HOTELS
LIGHTSTONE: PHASE 1**

**183
ROOMS**



OCEANWIDE PLAZA (DELAYED)

HOTEL ROOMS WITHIN WALKING DISTANCE OF LACC

There are 15 projects entitled/in the planning phase and eight projects announced/under consideration

UPCOMING		
23	Olympia	1,000
24	JW Marriott Expansion	850
25	The Albany (Sandstone Properties)	730
26	Morrison Hotel (Relevant Group)	444
27	Olympic Tower Hotel (Car Wash Site)	373
28	Fig+Pico Conf. Center Hotels (Lightstone) Ph. II	342
29	South Park Towers (Venice Hope Group, LLC)	300
30	Cambria Hotels & Suites	247
31	dtLA South Park (AECOM Capital)	243
32	The Reef (LA Mart)	208
33	The Bricks	200
34	Crown Group (11th + Hill)	160
35	Home2 Suites	143
36	Hyatt Centric (Blue Arch Investments)	139
37	W Hotel (Figueroa North, Hazens L.A. Center)	125
Subtotal		5,504
OPPORTUNITY SITES		
38	9th Street Sites	400
39	Pico + Hope/Flower	350
40	Toyota (L&R Group of Companies)	250
41	AEG (Desmond)	160
42	Mart South	149
43	Hope Street I	112
44	Regalian LLC	-
45	Honda	-
Subtotal		1,421



UPCOMING AND PROPOSED PROJECTS

1,000 ROOMS



OLYMPIA

850 ROOMS

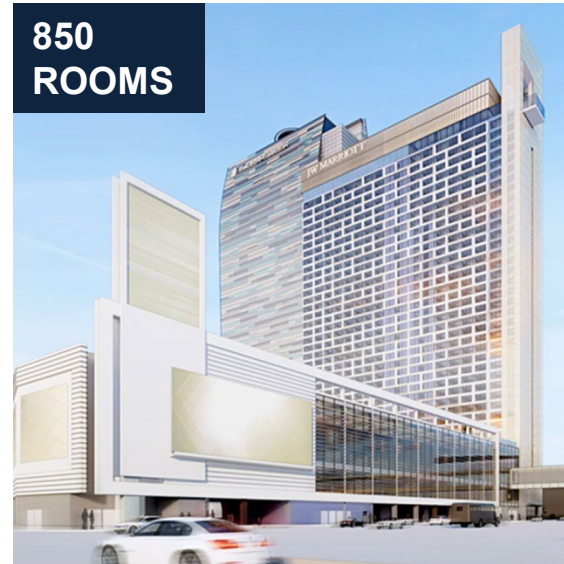

JW MARRIOTT EXPANSION

730 ROOMS

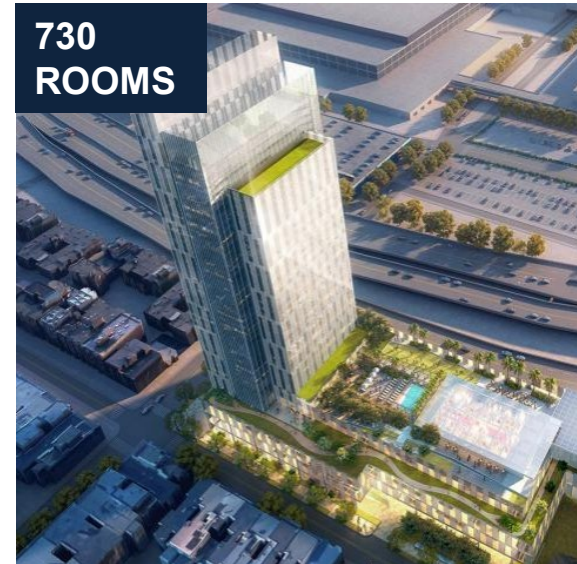

THE ALBANY (SANDSTONE)

473 ROOMS



MORRISON HOTEL

373 ROOMS

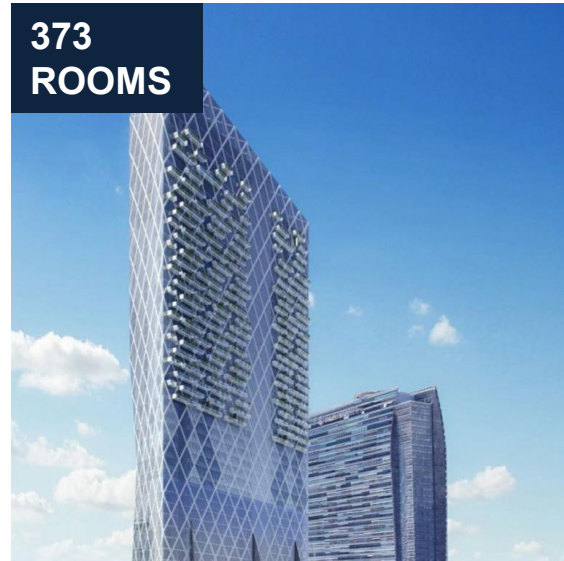

OLYMPIC TOWER HOTEL

342 ROOMS



LIGHTSTONE: PHASE II

300 ROOMS

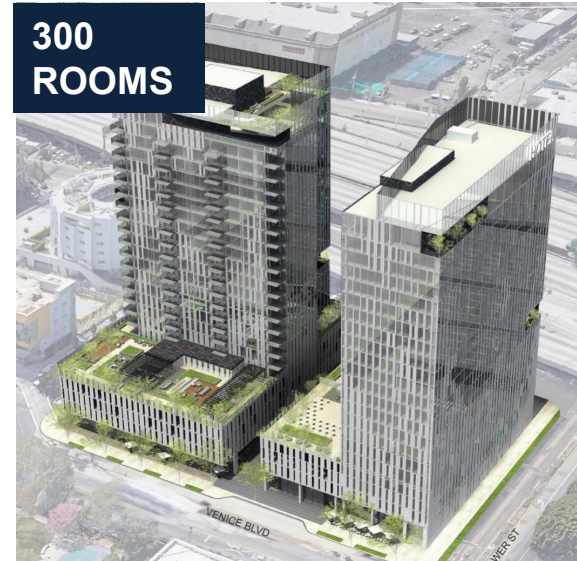

SOUTH PARK TOWERS

THANK YOU



<https://tourism.lacity.org/>