

Key Achievements

- Delivered over 1M SF in capital improvements at COH Los Angeles over the last seven years
- COH Orange County Cancer Center (Open August 2022) and Hospital in Progress
- Four community practices activation under hospital license



What's Next

- Duarte Outpatient Center (DOC)
 - Completes 2024
- Central Utility Plant Building
 - Completes 2024
- Orange County Expansion
 - Cancer Center & Parking Structure
 - Open 2022
 - Inpatient Hospital
 - Open 2025
 - Community practices
- Continued Growth in Community
- National Presence (CTCA)
- Next iteration of master planning soon to begin



Parking Garage A
Activated & In-Use

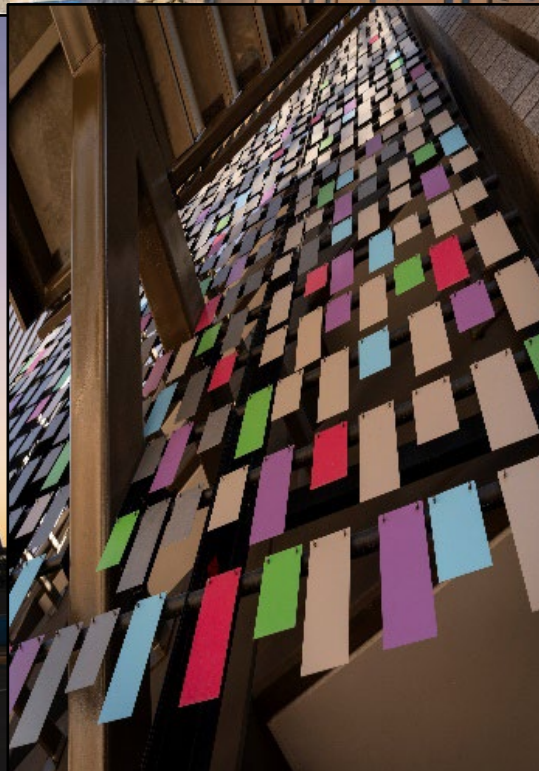
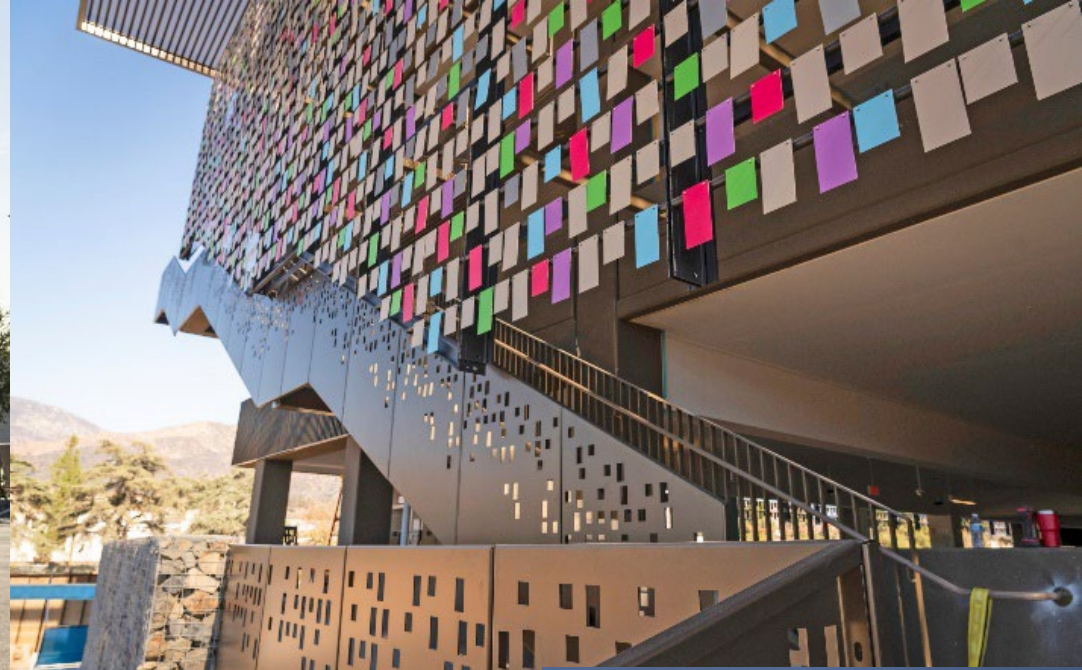

Hope Village Hotel
Activated April 2022



Hope Village Hotel
Activated April 2022





Warsaw Clinic (SEAC)



Duarte Outpatient Center 2024



Duarte Outpatient Center 2024







Orange County Cancer Center and Hospital



Orange County 11 acres Campus

Cancer Center:

- Infusion bay: 53
- Exam rm: 65
- OR: 3 + 2 procedure rms
- IR: 1
- Linac: 3
- MRI: 2
- CT/Pet: 2+2
- Gen Rad: 1
- RF: 1
- USP 800 Pharmacy

Hospital:

- Med surg: 45
- ICU: 28
- OR: 3 + 1 procedure rm
- ETC: 8
- CT: 1
- RF: 1
- USP 800 Pharmacy

- Cancer Center 189,000 SF
- Floors: 4
- 18 outpatient beds
- Construction Complete: April 2022
- 1st patient August 2022

- Parking Structure 1,046 Stalls
- Levels: 3
- Construction Complete: June 2025

- Hospital 170,000 SF
- Levels: 6
- 73 inpatient beds
- Construction Start: June 2022
- Construction Complete: July 2025
- 1st patient September 2025*

* Floors 5 and 6 shelled

COH Phoenix, Chicago, & Atlanta (Previous CTCA)



Zion (50 miles outside Chicago, IL) - 450,000 SF



Newnan, GA (40 miles outside Atlanta) - 485,000 SF



Goodyear, AZ (20 miles outside Phoenix) - 300,000 SF

