



LONG BEACH CITY COLLEGE

2024 FACILITIES MASTER PLAN UPDATE



**LIBERAL ARTS
CAMPUS**

DEVELOPMENT HISTORY



Long Beach City College was founded in 1927, and moved to the Liberal Arts Campus in 1935.

The graphic illustrates campus development, color-coded by the decade in which original construction occurred. Icons indicate building reconstruction(s), color-coded by decade per the legend.

BUILDING A, 1940's



BUILDING M, 2020's



FACILITIES CONDITION INDEX



The California Community College Chancellor's Office (CCCCO) conducts surveys of college campuses at regular intervals and assigns Facilities Condition Index (FCI) scores to buildings.

The FCI is a ratio of deferred maintenance dollars to replacement dollars and provides a straightforward comparison of the campus' building assets.

- The majority of the original buildings constructed on campus have FCI numbers greater than 50% indicating a high need for attention.
- Many of the buildings needing attention are inefficient and underutilized.

PROJECT DESCRIPTIONS

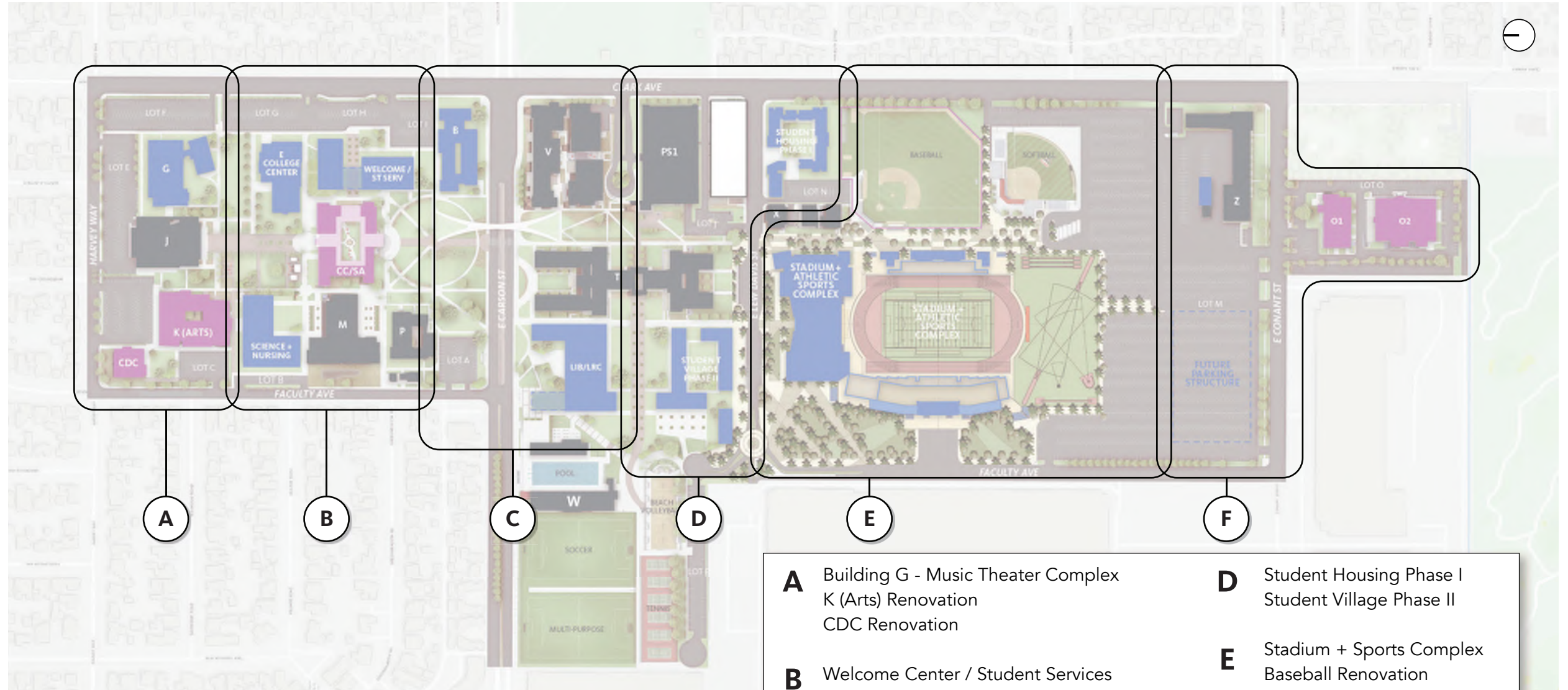

Descriptions for proposed facilities and site development projects are grouped into zones as shown in this key plan on the following pages.

In addition, a series of site development projects are proposed throughout the campus including landscape, artwork, signage, way finding, infrastructure, and sustainability.

A	Building G - Music Theater Complex K (Arts) Renovation CDC Renovation	D	Student Housing Phase I Student Village Phase II
B	Welcome Center / Student Services Building E - College Center Cultural Centers / Student Affairs Science + Nursing	E	Stadium + Sports Complex Baseball Renovation
C	Building B Library / Learning Resource Center Carson Street Crossing	F	Facilities Storage O1 & O2 Renovation Future Parking Structure

CLASSROOMS

**TRADES, TECHNOLOGY,
AND COMMUNITY
LEARNING CAMPUS**

DEVELOPMENT HISTORY

Long Beach City College was founded in 1927. During and after World War II, rapid college growth led to the establishment of this campus in 1949. The site, formerly Hamilton Junior High School, was first used as LBCC's Business and Technology Division. This was later named the Pacific Coast Campus and in 2024 became the Trades, Technology, and Community Learning Campus.

The graphic illustrates campus development, color-coded by the decade in which original construction occurred. Icons indicate building reconstruction(s), color-coded by decade per the legend.

BUILDING GG, 2010's



BUILDING DD (1930's) + EE (1950's)



- 2020's
- 2010's
- 2000's
- 1980's
- 1970's
- 1950's
- 1930's
- R Renovation
- Connex Boxes



FACILITIES CONDITION INDEX

The California Community College Chancellor's Office (CCCCO) conducts surveys of college campuses at regular intervals and assigns Facilities Condition Index (FCI) scores to buildings. The FCI is a ratio of deferred maintenance dollars to replacement dollars and provides a straightforward comparison of the campus' building assets.

The original buildings constructed on campus that have FCI numbers greater than 50% indicate a high need for attention. This diagram summarizes the scores reported on FUSION. This information was used to inform the planning discussions related to renovating versus replacing under performing buildings to support program needs.



- GOOD CONDITION
- FAIR CONDITION
- POOR CONDITION (NEEDS ATTENTION)



PROJECT DESCRIPTIONS

The following section includes descriptions for proposed facilities and site development projects, grouped in zones as shown in this key plan.

In addition, a series of site development projects are proposed throughout the campus including landscape, artwork, signage, way finding, infrastructure, and sustainability.

- A**
 - Gateway Entry
 - Welcome Center + Expanded Parking
 - Amphitheater
 - Horticulture Complex
 - Facilities
 - Renovations
- B**
 - New Quad
 - Potential Future Expansion



Construction Updates



Project List

Ongoing Projects (approx. ~\$700M)

- Construction Trades MM Phase 2
- Music and Theater Arts Bld. G.
- North Long Beach Student Housing
- Student & Athletics Sports Complex (SASC)

Upcoming Projects in 2025 (approx. ~\$284M)

- Building B Project
- Building E Project
- LAC Student Housing
- Welcome Center at TTC
- Dreamscape
- Baseball Complex
- Access Control 1

Construction Update – DBB Bidding

Building E Project



Scope:

- Demolition and New Construction of a three-story 58,000 GSF College Center.

Status/ Impact:

- Currently in Final DSA Review- Entering Bidding
- Design-Bid-Build delivery method.

Dates:

- Est. Bid opening: 3/15/2025.
- Substantial Completion: March, 2027.

Cost:

- Construction budget: \$61M

Construction Update – PDB Procurement

LAC Student Housing

Scope:

- Up to 4-stories, with 419-beds mix. approximate 93,000 GSF.

Status/ Impact:

- Supporting LBCC in the Housing Policy Development.
- Design-Build Pre-qualification phase.

Dates:

- RFP Phase Starts End of February
- Completion date Fall/2028

Cost:

- Construction budget = \$75M



Construction Update – Design Phase

Stadium & Athletics Sports Complex (SASC)



Scope:

- Demolition of the existing stadium and construction of the new stadium and athletic sports complex. Approximate 180,000 GSF.

Status/ Impact:

- 100% SD submitted.
- New state of the art sports facility for LBCC.
- Progressive Design Build delivery method.

Dates:

- Design DD Phase starts End of February

Cost:

- Total project budget = \$250M

Construction Update – Programming

TTC Welcome Center

Scope:

- New Welcome Center approximate 30,000 GSF, outdoor amphitheater, and campus access/site improvements.

Status/ Impact:

- Pre-design phase. Programming.
- Delivery method TBD.

Dates:

- Design to Start April/2025

Cost:

- Total project budget = \$45M



Construction Update – Programming Building B Project

Scope:

- Building B replacement with upgrades to classrooms, class labs, and offices. 43,000 GSF.

Status/ Impact:

- Programming phase, Architect selection for criteria document.
- Design Build delivery method.

Dates:

- Design to Start April/2025

Cost:

- Total project budget = \$52M

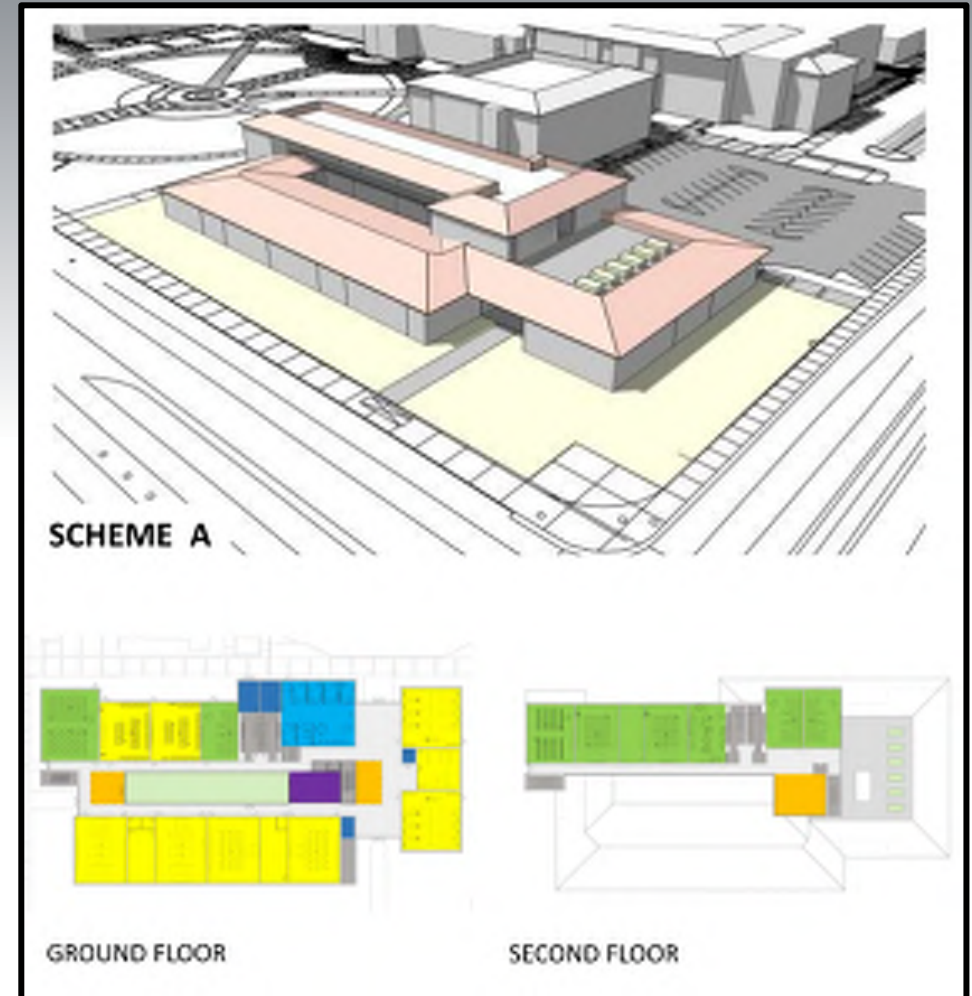

Construction Update – Design Phase

Dreamscape Project



Scope:

- Provide infrastructure to support the installation of Virtual Reality environments in Building L, Dreamscape.

Status/ Impact:

- 100% SD submitted.
- New state of the art sports facility for LBCC.
- Design-Bid-Build delivery method.

Dates:

Design DD Phase starts End of February

Cost:

- Total project budget = \$1.5M

Construction Update – Design Phase

Viking Baseball Complex

Scope:

- New Baseball Fields and Stadium adjacent to SASC

Status/ Impact:

- Updating sports facilities throughout campus.
- Design-Bid-Build delivery method.

Dates:

- Est. completion Summer/2027

Cost:

- Total project budget = \$12.9M





Questions & Answers

Contact information:

Hakim Chambers

Email: hchambers.bmt@lbcc.edu