



CONSTRUCTION NETWORK

Connecting Owners to AEC and CM Industries

K-12 Bond Programs

Project Updates & Contracting Opportunities

4/29/25

Santa Ana USD

Ted Walstrom

Assistant Superintendent

Irvine USD

Kelvin Okino

*Executive Director,
Facilities and Construction*

Tustin USD

Tom Rizzuti

Director, Facilities and Planning

Fullerton Joint Union High School District

Vince Madsen

Director of Facilities

Whittier Union High School District

Danny True

Manager of Construction Services

Fullerton School District

Mike McAdam

*Director of Purchasing, Warehouse,
Contracts & Reprographics*

Fullerton Joint Union High School District

Vince Madsen

Director Facilities, Maintenance & Operations

vmadsen@fjuhsd.org

714.680.5601



Website: www.fjuhsd.org

Measure L Bond - Capital Facilities Program

**FULLERTON JOINT UNION HIGH
SCHOOL DISTRICT**



**Uniting Communities
Engaging Minds
Building Futures**

PROJECT SUMMARY

CURRENT CURRENT PROJECTS (in design)

- Fullerton Union High School 2-Story Athletic Building
- Sunny Hills High School Track & Field Replacement
- Sonora High School Track & Field Replacement
- Sonora High School Science Classroom Modernization
- Troy High School Track & Field Replacement
- Troy High School Seismic Upgrade

PROPOSED MASTER PLAN

- Fullerton Joint Union High School District / 2024 Facilities Master Plan

Buena Park High School



Buena Park High School

Fullerton Union High School



Fullerton Union High School

La Habra High School



La Habra High School

La Vista / La Sierra High Schools



La Vista / La Sierra High Schools

Sonora High School



Sonora High School

Sunny Hills High School



Sunny Hills High School

Troy High School



Troy High School



Buena Park High School - Master Plan

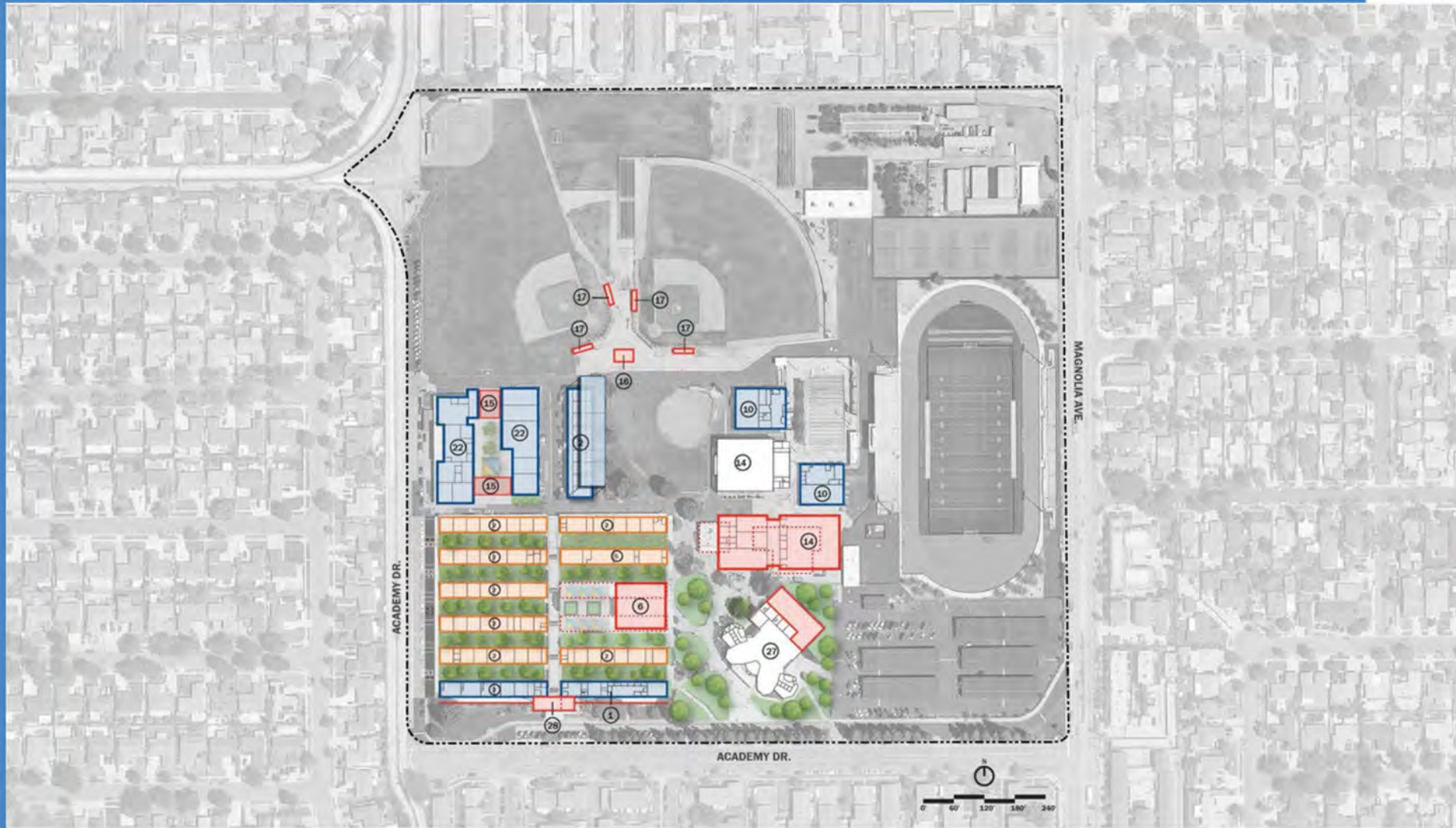

- | | | | | | |
|--|------------------------|---|----------------------------|--------------------------------|--------------------------------|
|  | DEMOLISH |  | CONCRETE | 1. ADMIN | 17. DUG OUT |
|  | NEW BUILDING/STRUCTURE |  | ASPHALT: PARKING/DROP OFF | 2. 9-12TH | 18. AGRICULTURAL GARDENS/FIELD |
|  | MODERNIZED BUILDING |  | HARDSCAPE: PLAY AREAS | 3. SPECIALTY CLASSROOM | 19. FIELD FITNESS AREA |
|  | RENOVATED BUILDING |  | LANDSCAPE: FIELDS | 4. MPR | 20. DINING COMMONS |
|  | RENOVATED RESTROOM |  | RUBBERIZED SURFACE: KINDER | 5. MEDIA CENTER | 21. SCIENCE LABS |
|  | PROPERTY FENCE |  | ALL WEATHER TRACK | 6. FOOD SERVICE | 22. CTE |
|  | OUTDOOR LEARNING |  | SITE WALL | 7. STUDENT SUPPORT SPACE | 23. HYDROPONICS LAB |
| | | | | 8. LUNCH SHELTER | 24. AGRICULTURAL PROGRAM |
| | | | | 9. SHADE STRUCTURE | 25. FITNESS STATIONS |
| | | | | 10. LOCKERS | 26. FIELD HOUSE/STORAGE |
| | | | | 11. LIBRARY | 27. PERFORMING ARTS CENTER |
| | | | | 12. TEACHER LOUNGE | 28. ENTRY LOBBY |
| | | | | 13. RESTROOMS | 29. PARKING STRUCTURE |
| | | | | 14. GYM | 30. BLEACHERS |
| | | | | 15. SOLID CANOPY | 31. MUSIC |
| | | | | 16. CONCESSION STAND/RESTROOMS | |



**Uniting Communities
Engaging Minds
Building Futures**

Fullerton Union High School - Master Plan

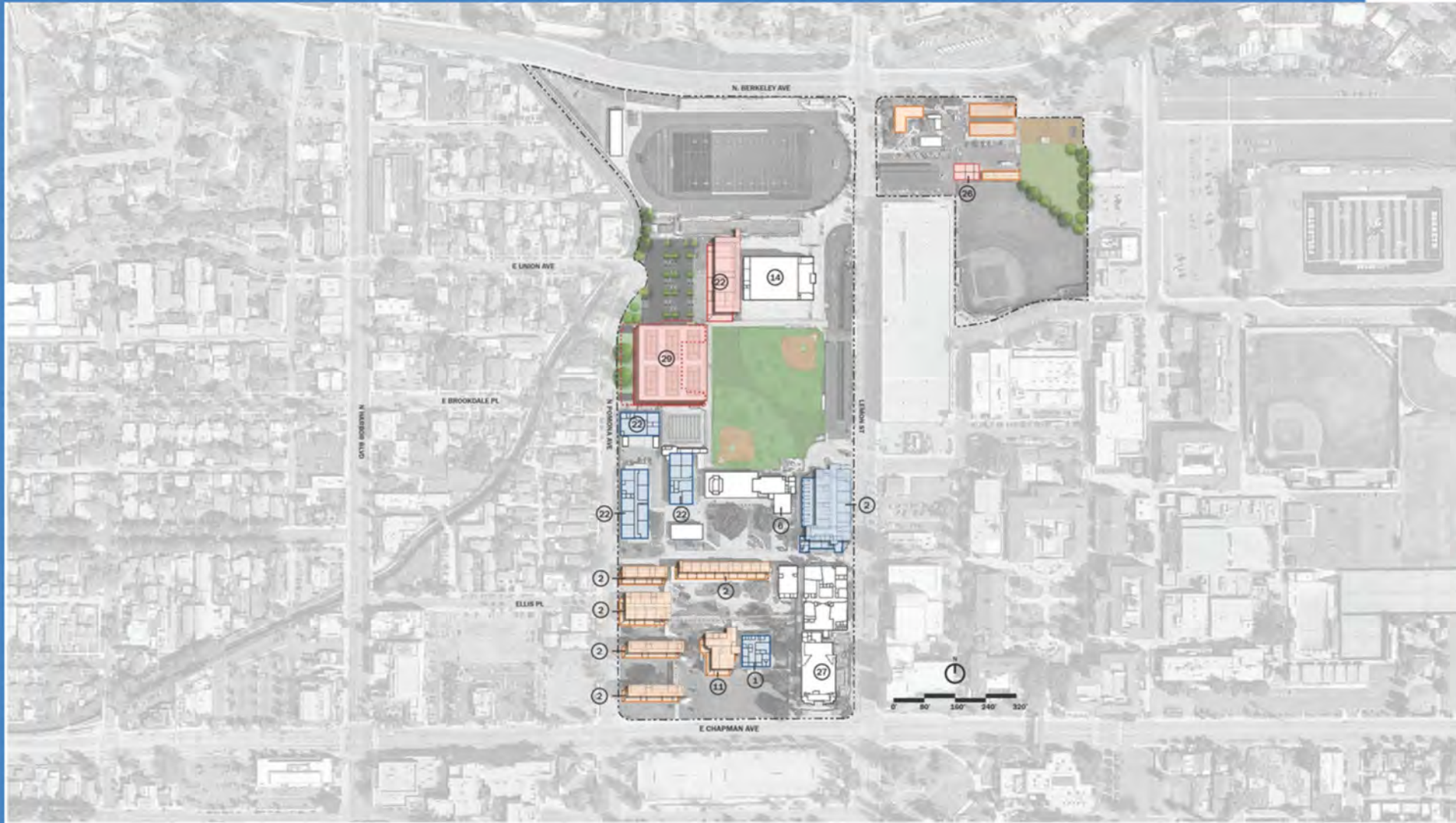

-  DEMOLISH
-  NEW BUILDING/STRUCTURE
-  MODERNIZED BUILDING
-  RENOVATED BUILDING
-  RENOVATED RESTROOM
-  PROPERTY FENCE
-  OUTDOOR LEARNING

-  CONCRETE
-  ASPHALT: PARKING/DROP OFF
-  HARDSCAPE: PLAY AREAS
-  LANDSCAPE: FIELDS
-  RUBBERIZED SURFACE: KINDER
-  ALL WEATHER TRACK
-  SITE WALL

- 1. ADMIN
- 2. 9-12TH
- 3. SPECIALTY CLASSROOM
- 4. MPR
- 5. MEDIA CENTER
- 6. FOOD SERVICE
- 7. STUDENT SUPPORT SPACE
- 8. LUNCH SHELTER
- 9. SHADE STRUCTURE
- 10. LOCKERS
- 11. LIBRARY
- 12. TEACHER LOUNGE
- 13. RESTROOMS
- 14. GYM
- 15. SOLID CANOPY
- 16. CONCESSION STAND/RESTROOMS
- 17. DUG OUT
- 18. AGRICULTURAL GARDENS/FIELD
- 19. FIELD FITNESS AREA
- 20. DINING COMMONS
- 21. SCIENCE LABS
- 22. CTE
- 23. HYDROPONICS LAB
- 24. AGRICULTURAL PROGRAM
- 25. FITNESS STATIONS
- 26. FIELD HOUSE/STORAGE
- 27. PERFORMING ARTS CENTER
- 28. ENTRY LOBBY
- 29. PARKING STRUCTURE
- 30. BLEACHERS
- 31. MUSIC



**Uniting Communities
Engaging Minds
Building Futures**

La Habra High School - Master Plan



- DEMOLISH
- NEW BUILDING/STRUCTURE
- MODERNIZED BUILDING
- RENOVATED BUILDING
- RENOVATED RESTROOM
- PROPERTY FENCE
- OUTDOOR LEARNING

- CONCRETE
- ASPHALT: PARKING/DROP OFF
- HARDSCAPE: PLAY AREAS
- LANDSCAPE: FIELDS
- RUBBERIZED SURFACE: KINDER
- ALL WEATHER TRACK
- SITE WALL

1. ADMIN
2. 9-12TH
3. SPECIALTY CLASSROOM
4. MPR
5. MEDIA CENTER
6. FOOD SERVICE
7. STUDENT SUPPORT SPACE
8. LUNCH SHELTER
9. SHADE STRUCTURE
10. LOCKERS
11. LIBRARY
12. TEACHER LOUNGE
13. RESTROOMS
14. GYM
15. SOLID CANOPY
16. CONCESSION STAND/RESTROOMS

17. DUG OUT
18. AGRICULTURAL GARDENS/FIELD
19. FIELD FITNESS AREA
20. DINING COMMONS
21. SCIENCE LABS
22. CTE
23. HYDROPONICS LAB
24. AGRICULTURAL PROGRAM
25. FITNESS STATIONS
26. FIELD HOUSE/STORAGE
27. PERFORMING ARTS CENTER
28. ENTRY LOBBY
29. PARKING STRUCTURE
30. BLEACHERS
31. MUSIC



**Uniting Communities
Engaging Minds
Building Futures**

La Vista / La Sierra High Schools - Master Plan

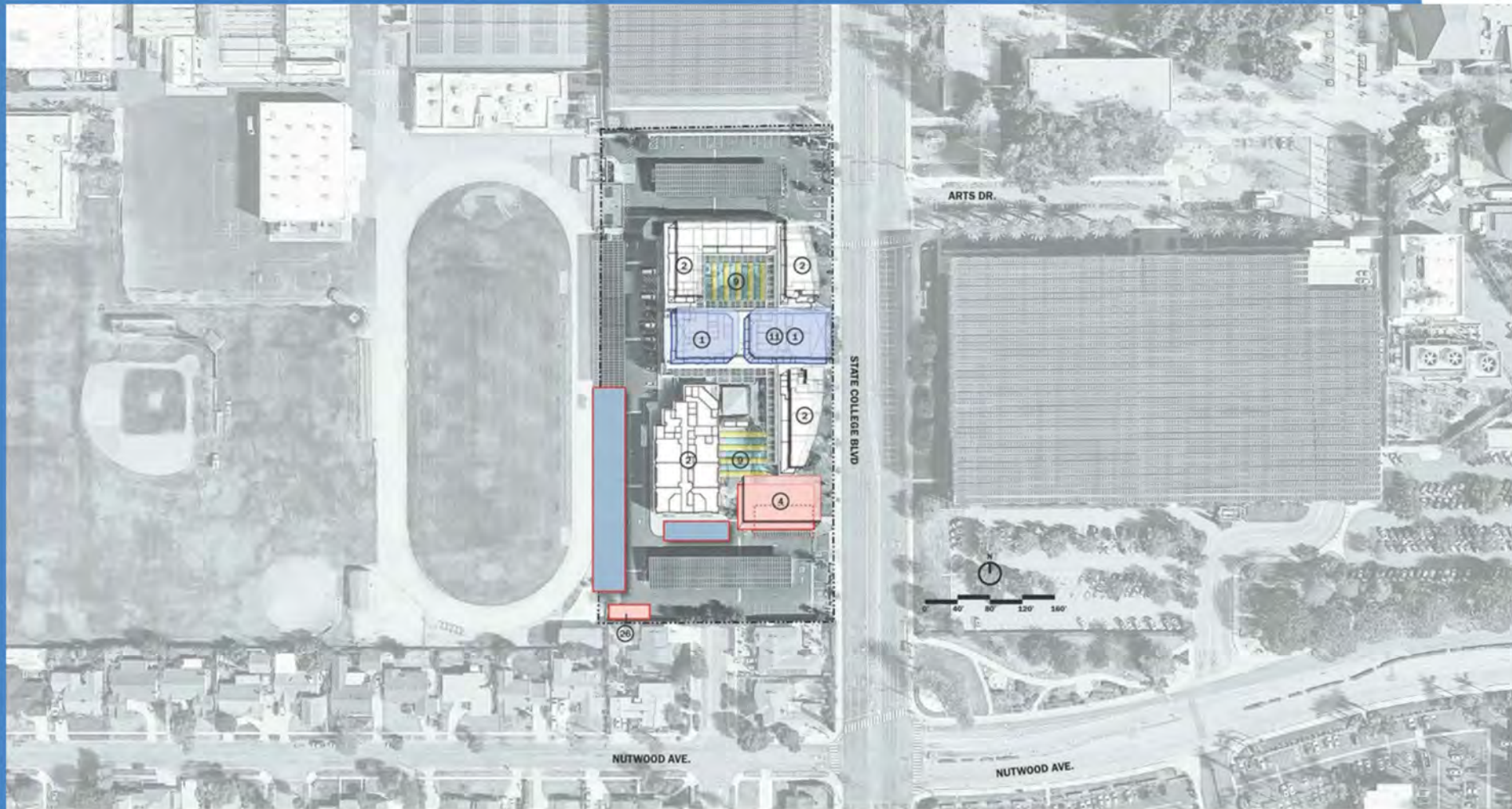

- | | | | | | |
|--|------------------------|---|----------------------------|--------------------------------|--------------------------------|
|  | DEMOLISH |  | CONCRETE | 1. ADMIN | 17. DUG OUT |
|  | NEW BUILDING/STRUCTURE |  | ASPHALT: PARKING/DROP OFF | 2. 9-12TH | 18. AGRICULTURAL GARDENS/FIELD |
|  | MODERNIZED BUILDING |  | HARDSCAPE: PLAY AREAS | 3. SPECIALTY CLASSROOM | 19. FIELD FITNESS AREA |
|  | RENOVATED BUILDING |  | LANDSCAPE: FIELDS | 4. MPR | 20. DINING COMMONS |
|  | RENOVATED RESTROOM |  | RUBBERIZED SURFACE: KINDER | 5. MEDIA CENTER | 21. SCIENCE LABS |
|  | PROPERTY FENCE |  | ALL WEATHER TRACK | 6. FOOD SERVICE | 22. CTE |
|  | OUTDOOR LEARNING |  | SITE WALL | 7. STUDENT SUPPORT SPACE | 23. HYDROPONICS LAB |
| | | | | 8. LUNCH SHELTER | 24. AGRICULTURAL PROGRAM |
| | | | | 9. SHADE STRUCTURE | 25. FITNESS STATIONS |
| | | | | 10. LOCKERS | 26. FIELD HOUSE/STORAGE |
| | | | | 11. LIBRARY | 27. PERFORMING ARTS CENTER |
| | | | | 12. TEACHER LOUNGE | 28. ENTRY LOBBY |
| | | | | 13. RESTROOMS | 29. PARKING STRUCTURE |
| | | | | 14. GYM | 30. BLEACHERS |
| | | | | 15. SOLID CANOPY | 31. MUSIC |
| | | | | 16. CONCESSION STAND/RESTROOMS | |



**Uniting Communities
Engaging Minds
Building Futures**

Sonora High School - Master Plan



DEMOLISH



NEW BUILDING/STRUCTURE



MODERNIZED BUILDING



RENOVATED BUILDING



RENOVATED RESTROOM

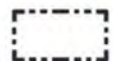

PROPERTY FENCE



OUTDOOR LEARNING



CONCRETE



ASPHALT: PARKING/DROP OFF



HARDSCAPE: PLAY AREAS



LANDSCAPE: FIELDS



RUBBERIZED SURFACE: KINDER



ALL WEATHER TRACK



SITE WALL

1. ADMIN
2. 9-12TH
3. SPECIALTY CLASSROOM
4. MPR
5. MEDIA CENTER
6. FOOD SERVICE
7. STUDENT SUPPORT SPACE
8. LUNCH SHELTER
9. SHADE STRUCTURE
10. LOCKERS
11. LIBRARY
12. TEACHER LOUNGE
13. RESTROOMS
14. GYM
15. SOLID CANOPY
16. CONCESSION STAND/RESTROOMS

17. DUG OUT
18. AGRICULTURAL GARDENS/FIELD
19. FIELD FITNESS AREA
20. DINING COMMONS
21. SCIENCE LABS
22. CTE
23. HYDROPONICS LAB
24. AGRICULTURAL PROGRAM
25. FITNESS STATIONS
26. FIELD HOUSE/STORAGE
27. PERFORMING ARTS CENTER
28. ENTRY LOBBY
29. PARKING STRUCTURE
30. BLEACHERS
31. MUSIC



**Uniting Communities
Engaging Minds
Building Futures**

Sunny Hills High School - Master Plan



DEMOLISH



NEW BUILDING/STRUCTURE



MODERNIZED BUILDING



RENOVATED BUILDING



RENOVATED RESTROOM



PROPERTY FENCE



OUTDOOR LEARNING



CONCRETE



ASPHALT: PARKING/DROP OFF



HARDSCAPE: PLAY AREAS



LANDSCAPE: FIELDS



RUBBERIZED SURFACE: KINDER



ALL WEATHER TRACK



SITE WALL

1. ADMIN
2. 9-12TH
3. SPECIALTY CLASSROOM
4. MPR
5. MEDIA CENTER
6. FOOD SERVICE
7. STUDENT SUPPORT SPACE
8. LUNCH SHELTER
9. SHADE STRUCTURE
10. LOCKERS
11. LIBRARY
12. TEACHER LOUNGE
13. RESTROOMS
14. GYM
15. SOLID CANOPY
16. CONCESSION STAND/RESTROOMS

17. DUG OUT
18. AGRICULTURAL GARDENS/FIELD
19. FIELD FITNESS AREA
20. DINING COMMONS
21. SCIENCE LABS
22. CTE
23. HYDROPONICS LAB
24. AGRICULTURAL PROGRAM
25. FITNESS STATIONS
26. FIELD HOUSE/STORAGE
27. PERFORMING ARTS CENTER
28. ENTRY LOBBY
29. PARKING STRUCTURE
30. BLEACHERS
31. MUSIC



**Uniting Communities
Engaging Minds
Building Futures**

Troy High School - Master Plan



-  DEMOLISH
-  NEW BUILDING/STRUCTURE
-  MODERNIZED BUILDING
-  RENOVATED BUILDING
-  RENOVATED RESTROOM
-  PROPERTY FENCE
-  OUTDOOR LEARNING

-  CONCRETE
-  ASPHALT: PARKING/DROP OFF
-  HARDSCAPE: PLAY AREAS
-  LANDSCAPE: FIELDS
-  RUBBERIZED SURFACE: KINDER
-  ALL WEATHER TRACK
-  SITE WALL

- 1. ADMIN
- 2. 9-12TH
- 3. SPECIALTY CLASSROOM
- 4. MPR
- 5. MEDIA CENTER
- 6. FOOD SERVICE
- 7. STUDENT SUPPORT SPACE
- 8. LUNCH SHELTER
- 9. SHADE STRUCTURE
- 10. LOCKERS
- 11. LIBRARY
- 12. TEACHER LOUNGE
- 13. RESTROOMS
- 14. GYM
- 15. SOLID CANOPY
- 16. CONCESSION STAND/RESTROOMS
- 17. DUG OUT
- 18. AGRICULTURAL GARDENS/FIELD
- 19. FIELD FITNESS AREA
- 20. DINING COMMONS
- 21. SCIENCE LABS
- 22. CTE
- 23. HYDROPONICS LAB
- 24. AGRICULTURAL PROGRAM
- 25. FITNESS STATIONS
- 26. FIELD HOUSE/STORAGE
- 27. PERFORMING ARTS CENTER
- 28. ENTRY LOBBY
- 29. PARKING STRUCTURE
- 30. BLEACHERS
- 31. MUSIC



**Uniting Communities
Engaging Minds
Building Futures**

ABOUT OUR DISTRICT

ONE OF FOUR SCHOOL DISTRICTS SERVING THE CITY OF IRVINE | ESTABLISHED IN 1972 | HOUSING DEVELOPMENTS CONTINUE WITHIN CITY OF IRVINE | +38,000 STUDENTS (2025)

45 SCHOOL SITES

- 24 Elementary Schools
- 5 K-8 Schools
- 6 Middle Schools
- 5 High Schools
- 1 Alternative High School
- 1 Early Childhood Learning Center
- 1 Adult Transition Program
- 2 Charter Schools
- 2 Virtual Academies | 1 Adult School



Irvine High School

STUDENT ENROLLMENT | GROWTH

- Medical Research and Health Community
- Regional Housing Needs Assessment (RHNA)
- Major Developers: The Irvine Co. and FivePoint



Stone Creek Elementary School

FUNDING

SCHOOLS FACILITIES IMPROVEMENT DISTRICT (SFID)

- Bond Measure "E" passed June 7, 2016
- \$319.0 million (sold \$241.0 million to date)
- 28 of 45 school sites within SFID

COMMUNITY FACILITIES DISTRICT (CFD)

- Similar to Mello-Roos but for school facilities



Bonita Canyon Elementary School

FACILITIES PLANNING DEPT and CONSTRUCTION SERVICES DEPT

- TWO DISTINCT DEPARTMENTS
 - Fifteen staff
 - Kelvin Okino, Executive Director | kelvinokino@iusd.org | (949) 936-5305
- DEPARTMENT RESPONSIBILITIES INCLUDE
 - Enrollment Projections
 - Facilities Planning and Design Phase Management
 - Construction Phase Oversight (Procurement: CM Multiple Prime)
 - Facilities Site Improvements
- SEPARATE FROM MAINTENANCE, OPERATIONS, AND TRANSPORTATION

PROJECTS UNDER CONSTRUCTION

- Portola HS Classroom Expansion
- Nutrition Services Classroom Expansion

PROJECTS IN DESIGN

- University HS New Performing Arts Center (Measure E)
- Northwood HS New Practice Gym (Measure E)
- Lakeside MS New MPR/Music (Measure E)
- College Park ES New Nutrition Services (Measure E)
- Venado MS MPR Improvements (Measure E)
- Sierra Vista MS MPR Expansion
- Beacon Park School Classroom Expansion
- Cadence Park School Classroom Expansion
- Canyon View ES Classroom Expansion
- Oak Creek ES Classroom Expansion
- Stonegate ES Classroom Expansion

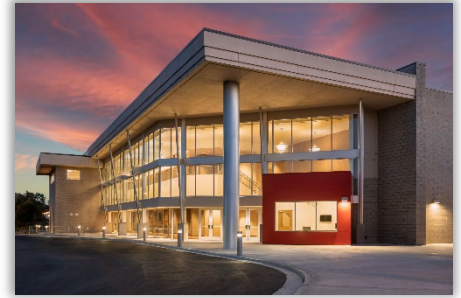

Woodbridge High School



Solis Park School



Loma Ridge Elementary School

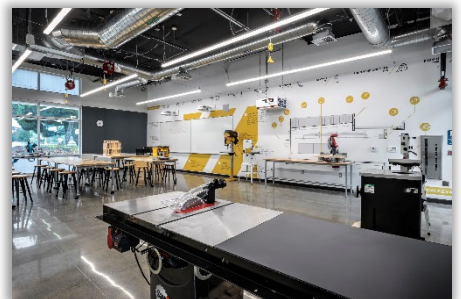

Creekside High School

PROJECTS IN PLANNING

- Woodbridge HS Modernization (Measure E)
- Sierra Vista MS Expansion (Measure E)
- College Park ES Expansion (Measure E)
- Eastshore ES Expansion (Measure E)
- Stone Creek ES Expansion (Measure E)
- Turtle Rock ES Expansion (Measure E)
- Westpark ES Expansion (Measure E)
- Districtwide
 - School Modernizations / School Expansions
 - Facilities Master Plan Update

OPPORTUNITIES

- CONSULTING FIRMS ON APPROVED POOL
 - Architects, Construction Managers
 - Materials Testing and Inspection
 - Geotechnical Investigation and Monitoring
 - DSA Inspectors
 - Labor Compliance, Survey, Environmental
- PRIME CONTRACTORS PREQUALIFIED
 - Construction Management Multiple Prime Delivery Method



Brywood Elementary School



FULLERTON
SCHOOL
DISTRICT

Mike McAdam

Director of Purchasing, Warehouse, Contracts & Reprographics

(714) 447-2846

Mike_McAdam@myfsd.org

About Fullerton School District

FSD formed in 1888, one year after the founding of the City of Fullerton

Est . 11,556 students grades K-8 in a 26 sq mile area

15 elementary schools, 2 (K-8) and 3 Junior High Schools

690 teachers and other certificated staff

828 classified staff

Fullerton Union High School District is separate from us.

Bond Dollars at Work

Bond Measure “N” passed

\$262.0 million

PROJECTS UNDER CONSTRUCTION

Nicolas Jr High School “Cube Design” Gym

Park Jr High School “Cube Design” Gym

PROJECTS IN DESIGN

Marquee

Playgrounds

Pour and Play



Future Projects

Dance Studio

New Gym

Bathroom upgrades

HVAC

Electrical

Plumbing

Removal of portable buildings

Access controls



TUSTIN UNIFIED SCHOOL DISTRICT PROJECT SUMMARY

Projects in Design



Measure J

- Modernization of Arroyo Elementary School
- Modernization of Loma Vista Elementary School
- Modernization of Benjamin Beswick Elementary School



Facilities Master Plan



For more information please contact:
Tom Rizzuti, Director of Facilities and Planning
(949) 293-4850
trizzuti@tustin.k12.ca.us